

# Terminology

- 1- Door sill
- 2- Head jamb
- 3- Side jamb
- 4- Fixed Panel
- 5- Operating panel
- 6- Weep holes
- 7- Nailing fin(optional)

# INSTALLATION GUIDE (Gliding Patio Door)

**Important! : Read the instructions carefully before beginning installation. Failure to install as recommended will void warranty.**

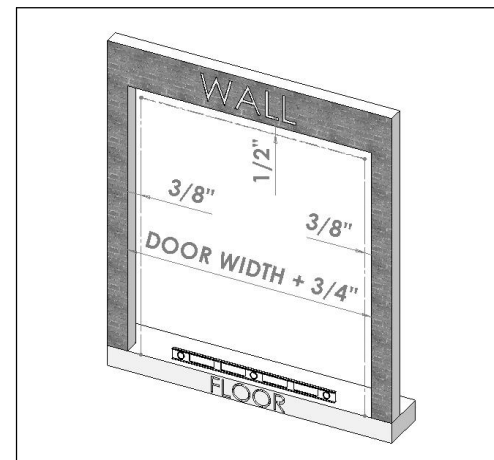

FIGURE 1

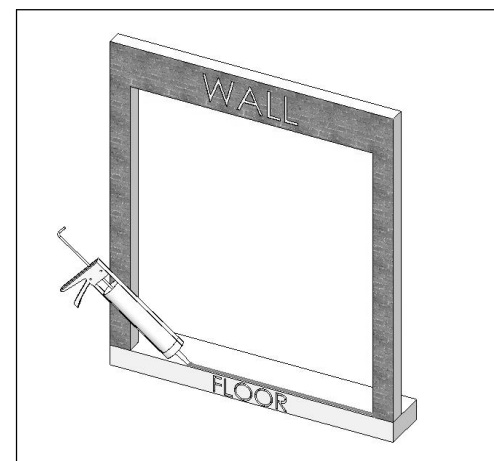

FIGURE 2

### Preparing the Opening

**1-** Measure the opening for proper clearance between the vinyl frame and rough opening. There should be 3/8" space on the sides and 1/2" at the top.(FIGURE 1)

**2-** Clean the bottom of the door opening and check for level using of at least a 4' length level. **Caulking will not stick to dusty or moist surfaces.**(FIGURE 2)

**3-** If floor is at level, apply two beads, 1/4" of high quality caulk on the floor where the unit will be installed. (FIGURE 2)

If floor is not at level, wait for step 2 of "Fitting the door into place" before applying caulk on each side of the sill.

### Installing the Door

Remove all the packaging from the door: plastic film, straps, cardboard corners, wood blocks. If you use a sharp tool be very careful not to scratch the PVC surfaces.

Once you have prepared the opening to receive the door, set the bottom of the door onto the floor and then gently tilt it until it is lined up with the sides of the opening. Make sure the door is properly centered.

### Installing the handle

**Installing handle on panels** - Set thumb latch into place facing inside. Fasten the 2 screws without over tightening not to deform the PVC.

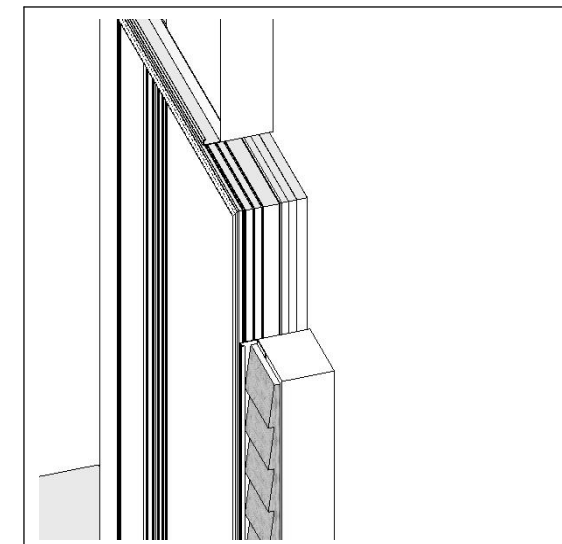
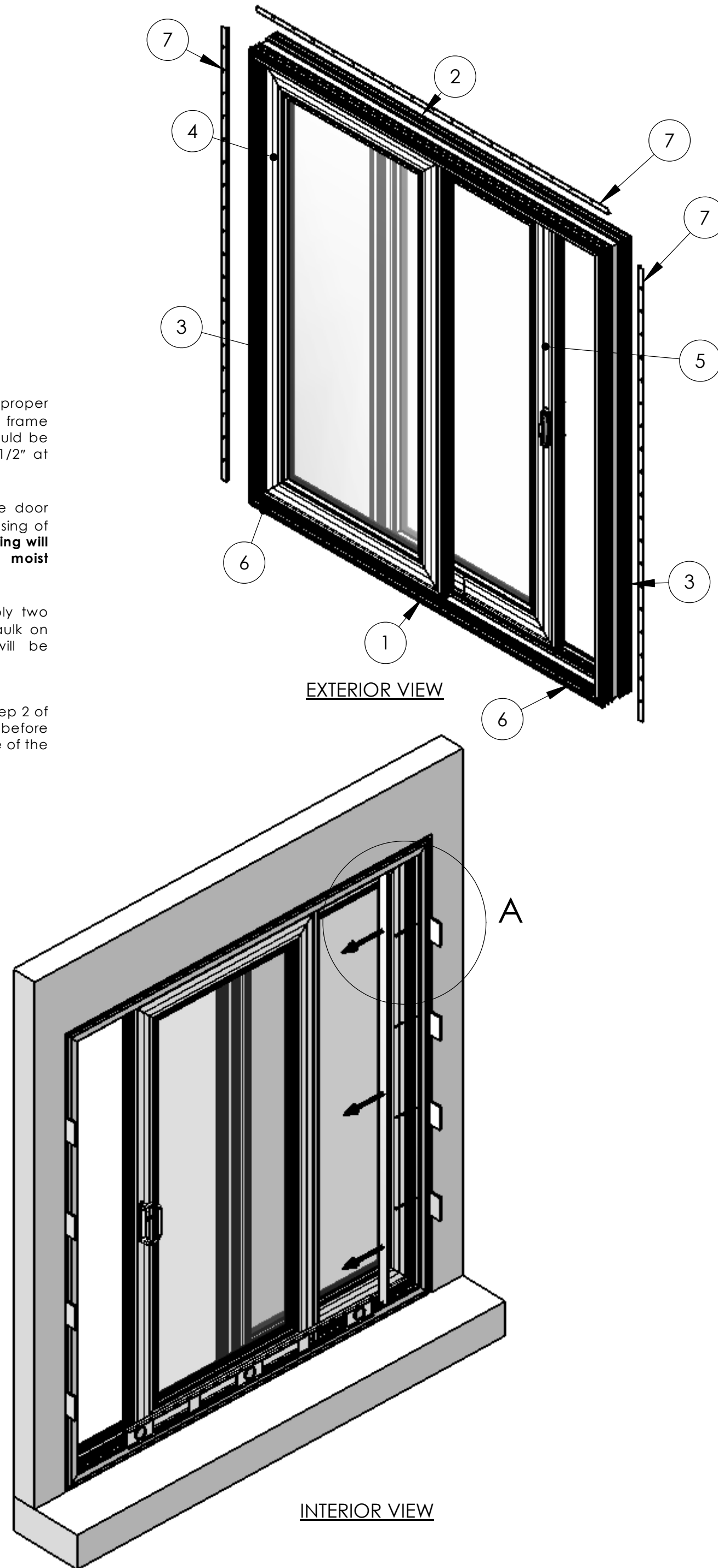

FIGURE 3

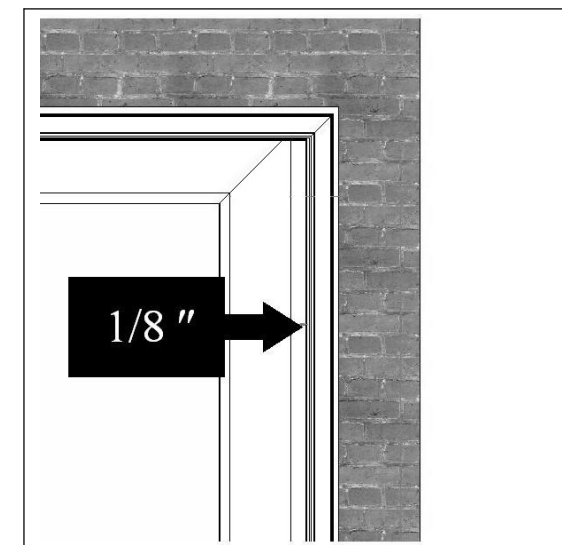

FIGURE 4

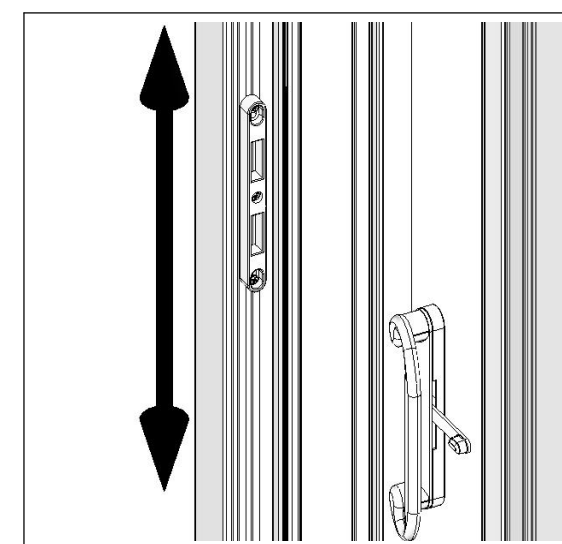

FIGURE 5

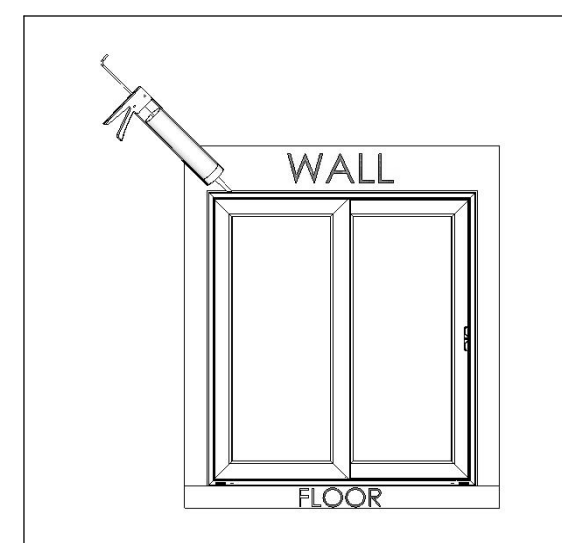

FIGURE 6

### Fitting the door into place

**1-** Insert the door into its opening. Make sure that the door is held by somebody else. The external surface of framing must exceed 1/4" out of the "J" cap all around the opening. To allow space for the sealant. (FIGURE 3) You can use nailing fin (offered as an option on "Imagine" door.) Note : Nailing fin are not installed on the door, you have to install it.

**2-** For proper operation of the door, the sill of the door must be levelled and straight. Use a 4' level and shim under the sill as required.

**3-** Open the active panel and locate the 4 predrilled holes in each side jamb, remove the interior jamb cover to show the 4 predrilled holes.

Insert shims at each screw hole between the frame opening and the jamb. Do not force the shims; hand tight is sufficient to hold them in place.(DETAIL A).

**4-** Open the active panel keeping a 1/8" gap between the active panel and the frame. Adjust shims to maintain the 1/8" gap vertically.

If adjustment with shims is adequate, go to point 5, if adjustment is not done correctly, further adjustment can be made with the rollers. The rollers of the operating panel are preset at zero at the factory. To correct the 1/8" gap, raise the rollers (FIGURE 4)

**Adjusting Rollers in operating panel-** Locate the hole in the edge near the bottom of the panel. Insert a #2 Phillips or Square-head SCREWDRIVER into the hole; turn the screw to raise or lower the roller as needed. Turning the screw clockwise raises the panel.

It is possible that the lock does not latch, to correct, adjust the strike plate vertically. (FIGURE 5)

**5-** Drive screws thru shims into wall. Repeat for fixed panel side jamb. Try not to screw through the sill of the frame.

**6-** Nail roofing nails thru the nailing fin into wall. (optional)

**7-** Insert the two weep hole covers (3/8" x2") into the edge of the sill.

**8-** Working from the inside out insulate between the doorframe and wall with loosely packed FIBERGLASS insulation material.

**NOTE: DO NOT SEAL THIS SPACE WITH AEROSOL EXPANDING FOAM. (The foam can over expand and apply pressure to the frame.)**

**9-** Before applying any outside or inside trims and flashing, apply high quality caulking where the fiberglass insulation material could not be applied. Do not fill weep holes. Don't omit any of the caulking steps and make sure that local building codes and manufacturers instructions are followed when applying insulation, air/water barriers, flashing and caulking.(FIGURE 6)

**10- Adjusting screen rollers** - With the screen sitting on the track, locate the top holes on the screen's edge. Insert #2 Phillips or Squared-head SCREWDRIVER into the holes and loosen top rollers. Adjust bottom rollers so that the screen from rocking. Turning the screw clockwise raises (extends) the roller.

### PVC Care

Clean PVC surfaces using a soft rag with mild soap diluted in warm water. Or you can use any special commercial cleener for PVC doors and windows. NEVER USE ABRASIVES NOR SOLVENTS, NOR ANY PETROLEUM-BASE PRODUCT. Such products can cause permanent damage to the PVC surfaces and will VOID ALL WARRANTY.

