

## PROCEDURE FOR INSTALLING THE SNAP-IN COVERS

1. Install the horizontal snap-in covers first making sure the mitred corner of the cover is aligned with the same mitre of the doorlite frame.
2. Next, install the vertical snap-in covers.



3. Start by installing one corner, then the other. Then press the snap-in cover down, starting from the corners and working towards the centre.



4. Insert the vertical snap-in covers by placing the corners up against the snap-in covers already installed. Press the snap-in cover down, starting from the corners and working towards the centre.

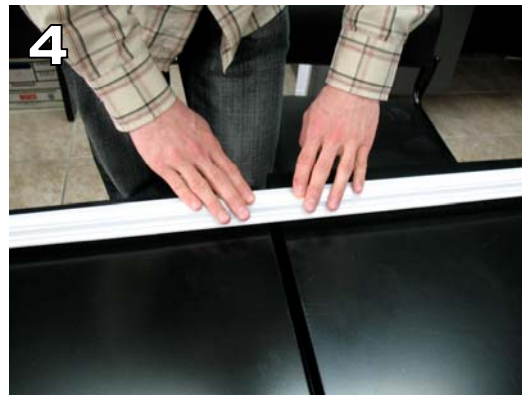

# Successful installation !

**Novatech<sup>®</sup>**